

## Newmarket Room - Stand Layout and Prices

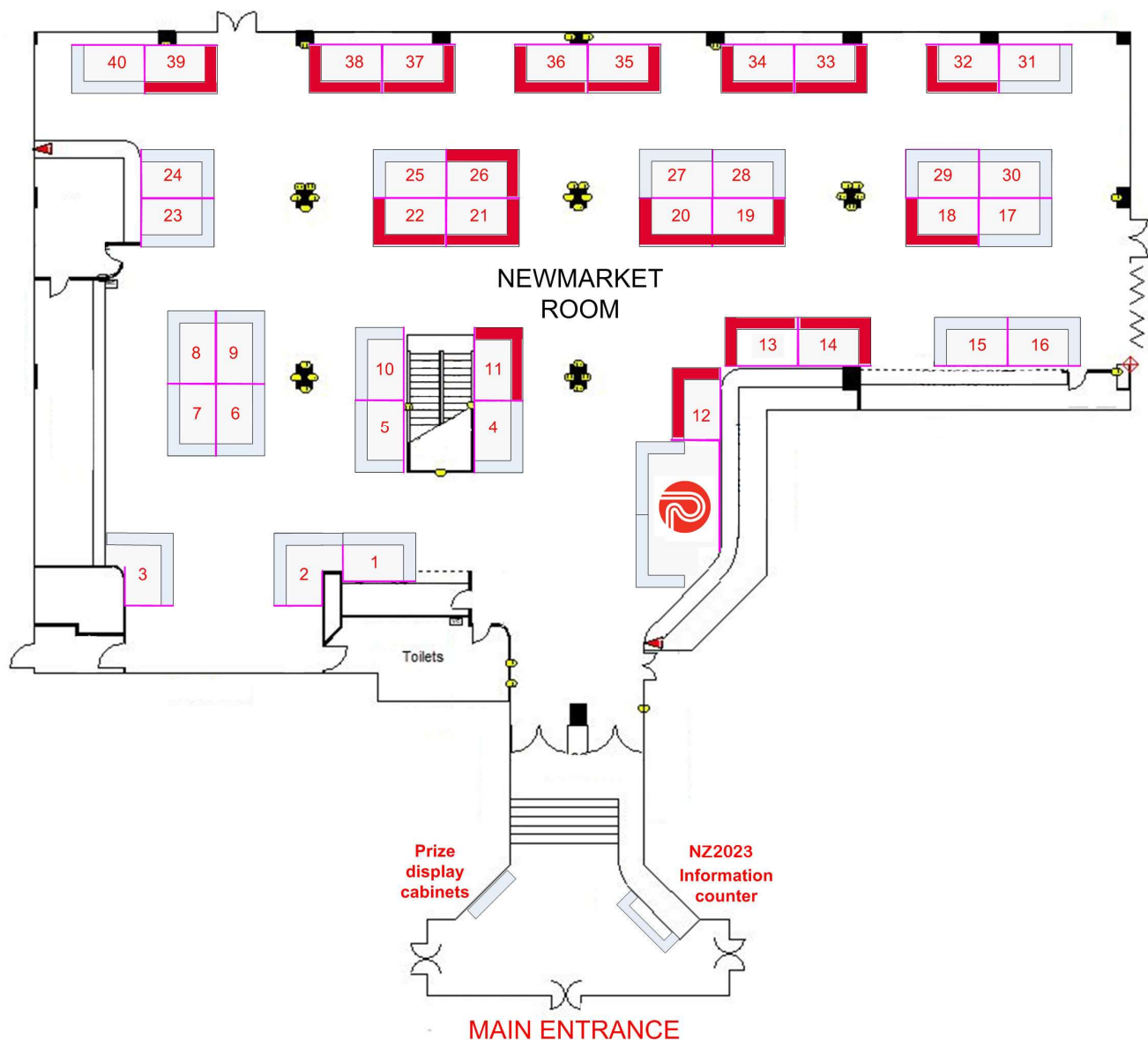

Stand	Price NZ\$	Stand	Price NZ\$	Stand	Price NZ\$	NOTES
1	3,450	15	2,875	29	2,300	Prices are quoted in NZ\$ inclusive of GST (currently 15%). Stands are 3.6m x 2.4m. Check the TRADE INFORMATION sheet for details of deposit, instalment payments, shared stands, payment methods, etc. TRADE STAND APPLICATION FORM requests you list 3 stands in order of preference for the Early Bird Ballot. <b>Details at 1 August 2022</b>
2	2,875	16	3,000	30	2,300	
3	2,600	17	2,875	31	1,725	
4	4,025	18	<b>SOLD</b>	32	<b>SOLD</b>	
5	3,450	19	<b>SOLD</b>	33	<b>SOLD</b>	
6	3,450	20	<b>SOLD</b>	34	<b>SOLD</b>	
7	2,875	21	<b>SOLD</b>	35	<b>SOLD</b>	
8	2,600	22	<b>SOLD</b>	36	<b>SOLD</b>	
9	3,175	23	2,875	37	<b>SOLD</b>	
10	3,175	24	2,300	38	<b>SOLD</b>	
11	<b>SOLD</b>	25	2,300	39	<b>SOLD</b>	
12	<b>SOLD</b>	26	<b>SOLD</b>	40	1,725	
13	<b>SOLD</b>	27	2,300			
14	<b>SOLD</b>	28	2,300			